



---

ZP4-C0060-42

60" Diameter X 42"H

# ZIP



Round  
ZP4-C0042-29



Square  
ZP4-C3636-29



Rectangle  
ZP4-C4872-29



Hex  
ZP6-C4296H-XR-42

## ZIP TABLE

- Available in square, round, rectangle and hex shapes.
- Table tops are high-pressure laminate and are banded with 3mm PVC. Square corners have a 1/8" radius.
- Legs are constructed from powder coated heavy-gauge steel. Each leg includes built-in wire management channel and a cover panel.
- Legs are supplied with adjustable glides.

### ZIP RECTANGLE TABLE STANDARD SIZES

MODEL	DEPTH"	WIDTH"	HEIGHT"
ZP4-C3648-__	36	48	29/36
ZP4-C3660-__	36	60	29/36
ZP4-C3672-__	36	72	29/36
ZP6-C3684-__	36	84	29/36
ZP6-C3696-__	36	96	29/36
ZP4-C4248-__	42	48	29/36/42
ZP4-C4260-__	42	60	29/36/42
ZP4-C4272-__	42	72	29/36/42
ZP6-C4284-__	42	84	29/36/42
ZP6-C4296-__	42	96	29/36/42
ZP4-C4860-__	48	60	29/36/42
ZP4-C4872-__	48	72	29/36/42
ZP6-C4884-__	48	84	29/36/42
ZP6-C4896-__	48	96	29/36/42

### ZIP SQUARE TABLE STANDARD SIZES

MODEL	DEPTH"	WIDTH"	HEIGHT"
ZP4-C3636-__	36	36	29/36
ZP4-C4242-__	42	42	29/36/42
ZP4-C4848-__	48	48	29/36/42
ZP4-C6060-__	60	60	29/36/42

### ZIP ROUND TABLE STANDARD SIZES

MODEL	DIAMETER"	HEIGHT"
ZP4-C0042-29	42	29
ZP4-C0048-__	48	29/36/42
ZP4-C0060-__	60	29/42/42

### To Order, Choose Finish Selections & Options

**Work Surface:** Choose from our selection of high pressure laminates.

**Edges:** Choose a PVC edgeband.

**Legs:** Choose from our powder coat selection.

See **MTContract's** finish choices at <https://www.mtcontract.com/resources/finishes>

### ZIP HEX TABLE STANDARD SIZES

MODEL	DEPTH"	WIDTH"	HEIGHT"
ZP6-C4296H-XR-__	42	96	29/36/42

#### EDGE TYPE



#### CORNERS



#### WIRE MANAGEMENT

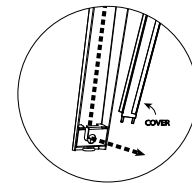

#### General Specifications

**Table Top:** Table tops are 1-1/4" thick, three-ply 45# particleboard construction with .050" high pressure laminate top surface and a .030" phenolic backer. Tops are banded with 3mm PVC. Square corners have a 1/8" radius.

**Legs:** Legs are constructed from powder coated heavy-gauge steel. Each leg includes built-in wire management channel and a cover panel. Legs are supplied with adjustable glides.

Note: Tables with a width greater than 72" receive 6 legs.