

PLEASE NOTE: The prices below are for reference only and are base models constructed of HPL work surfaces, TFL cabinets and doors with standard pulls, standard hinges and without locks. For detailed pricing please contact your local dealer or **mediatechnologies®**.

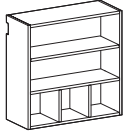

- 2 adjustable shelves

Wall Open Storage (WOS)		Melamine			High-Pressure Laminate	
Description	Wgt.	Model Number	List Price	Model Number	List Price	
18"W x 14"D x 24"H	36	WOS-181424-T	\$473	WOS-181424-L	\$657	
18"W x 14"D x 30"H	39	WOS-181430-T	\$476	WOS-181430-L	\$683	
24"W x 14"D x 24"H	44	WOS-241424-T	\$479	WOS-241424-L	\$685	
24"W x 14"D x 30"H	47	WOS-241430-T	\$491	WOS-241430-L	\$709	
30"W x 14"D x 24"H	52	WOS-301424-T	\$519	WOS-301424-L	\$778	
30"W x 14"D x 30"H	55	WOS-301430-T	\$527	WOS-301430-L	\$804	
36"W x 14"D x 24"H	59	WOS-361424-T	\$568	WOS-361424-L	\$926	
36"W x 14"D x 30"H	63	WOS-361430-T	\$589	WOS-361430-L	\$947	
42"W x 14"D x 24"H	73	WOS-421424-T	\$657	WOS-421424-L	\$1,032	
42"W x 14"D x 30"H	78	WOS-421430-T	\$674	WOS-421430-L	\$1,069	



- 1 adjustable shelf
- 18" & 24" W units will have 2 lower cubbies
- 30" & 36" W will have 3 lower cubbies

Wall Open Storage with Cubicle Storage		Melamine			High-Pressure Laminate	
Description	Wgt.	Model Number	List Price	Model Number	List Price	
18"W x 14"D x 30"H	39	WOSCB3-181430-T	\$515	WOSCB3-181430-L	\$759	
24"W x 14"D x 30"H	47	WOSCB3-241430-T	\$524	WOSCB3-241430-L	\$788	
30"W x 14"D x 30"H	58	WOSCB3-301430-T	\$547	WOSCB3-301430-L	\$836	
36"W x 14"D x 30"H	67	WOSCB3-361430-T	\$628	WOSCB3-361430-L	\$1,030	
42"W x 14"D x 30"H	82	WOSCB3-421430-T	\$755	WOSCB3-421430-L	\$1,264	



- 2 adjustable shelves

Wall Cupboard Storage (WCS)		Melamine			High-Pressure Laminate	
Description	Wgt.	Model Number	List Price	Model Number	List Price	
24"W x 14"D x 24"H	58	WCS-241424-TT-H?P?N	\$747	WCS-241424-LL-H?P?N	\$1,022	
24"W x 14"D x 30"H	64	WCS-241430-TT-H?P?N	\$783	WCS-241430-LL-H?P?N	\$1,105	
30"W x 14"D x 24"H	68	WCS-301424-TT-H?P?N	\$832	WCS-301424-LL-H?P?N	\$1,184	
30"W x 14"D x 30"H	76	WCS-301430-TT-H?P?N	\$871	WCS-301430-LL-H?P?N	\$1,264	
36"W x 14"D x 24"H	79	WCS-361424-TT-H?P?N	\$915	WCS-361424-LL-H?P?N	\$1,382	
36"W x 14"D x 30"H	88	WCS-361430-TT-H?P?N	\$954	WCS-361430-LL-H?P?N	\$1,466	
42"W x 14"D x 24"H	96	WCS-421424-TT-H?P?N	\$1,010	WCS-421424-LL-H?P?N	\$1,564	
42"W x 14"D x 30"H	111	WCS-421430-TT-H?P?N	\$1,070	WCS-421430-LL-H?P?N	\$1,694	

P-ELEMENTSWALL-240114



- 1 door hinged left
- 2 adjustable shelves

Wall Cupboard Storage Hinged Left (WCSL)			Melamine	High-Pressure Laminate		
Description	Wgt.	Model Number	List Price	Model Number	List Price	
18"W x 14"D x 24"H	45	WCSL-181424-TT-H?P?N	\$620		\$886	
18"W x 14"D x 30"H	51	WCSL-181430-TT-H?P?N	\$653	WCSL-181430-LL-H?P?N	\$963	
24"W x 14"D x 24"H	57	WCSL-241424-TT-H?P?N	\$666	WCSL-241424-LL-H?P?N	\$944	
24"W x 14"D x 30"H	64	WCSL-241430-TT-H?P?N	\$783	WCSL-241430-LL-H?P?N	\$1,023	

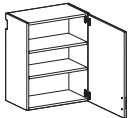

- 1 door hinged right
- 2 adjustable shelves

Wall Cupboard Storage Hinged Right (WCSR)			Melamine	High-Pressure Laminate		
Description	Wgt.	Model Number	List Price	Model Number	List Price	
18"W x 14"D x 24"H	45	WCSR-181424-TT-H?P?N	\$620	WCSR-181424-LL-H?P?N	\$886	
18"W x 14"D x 30"H	51	WCSR-181430-TT-H?P?N	\$653	WCSR-181430-LL-H?P?N	\$963	
24"W x 14"D x 24"H	57	WCSR-241424-TT-H?P?N	\$666	WCSR-241424-LL-H?P?N	\$944	
24"W x 14"D x 30"H	64	WCSR-241430-TT-H?P?N	\$783	WCSR-241430-LL-H?P?N	\$1,023	

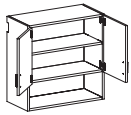

- 1 adjustable shelf

Wall Cupboard Storage with Open Storage (WCSOS)			Melamine	High-Pressure Laminate		
Description	Wgt.	Model Number	List Price	Model Number	List Price	
24"W x 14"D x 24"H	58	WCSOS-241424-TT-H?P?N	\$846	WCSOS-241424-LL-H?P?N	\$1,131	
24"W x 14"D x 30"H	64	WCSOS-241430-TT-H?P?N	\$893	WCSOS-241430-LL-H?P?N	\$1,215	
30"W x 14"D x 24"H	68	WCSOS-301424-TT-H?P?N	\$944	WCSOS-301424-LL-H?P?N	\$1,297	
30"W x 14"D x 30"H	76	WCSOS-301430-TT-H?P?N	\$984	WCSOS-301430-LL-H?P?N	\$1,376	
36"W x 14"D x 24"H	79	WCSOS-361424-TT-H?P?N	\$1,031	WCSOS-361424-LL-H?P?N	\$1,495	
36"W x 14"D x 30"H	88	WCSOS-361430-TT-H?P?N	\$1,069	WCSOS-361430-LL-H?P?N	\$1,575	
42"W x 14"D x 24"H	100	WCSOS-421424-TT-H?P?N	\$1,118	WCSOS-421424-LL-H?P?N	\$1,673	
42"W x 14"D x 30"H	111	WCSOS-421430-TT-H?P?N	\$1,176	WCSOS-421430-LL-H?P?N	\$1,830	

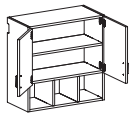

- 1 adjustable shelf
- 24" W units will have 2 lower cubbies
- 30" & 36" W units will have 3 lower cubbies

Wall Cupboard Storage with Open Cubicle Storage (WCSOCB3)			Melamine	High-Pressure Laminate		
Description	Wgt.	Model Number	List Price	Model Number	List Price	
24"W x 14"D x 30"H	72	WCSOCB3-241430-TT-H?P?N	\$1,086	WCSOCB3-241430-LL-H?P?N	\$1,152	
30"W x 14"D x 30"H	79	WCSOCB3-301430-TT-H?P?N	\$1,205	WCSOCB3-301430-LL-H?P?N	\$1,312	
36"W x 14"D x 30"H	92	WCSOCB3-361430-TT-H?P?N	\$1,310	WCSOCB3-361430-LL-H?P?N	\$1,513	



- 1 fixed partition
- 4 adjustable shelves

Wall Cubicle Storage - 6 Cubicles (WOCB6)			Melamine	High-Pressure Laminate	
Description	Wgt.	Model Number	List Price	Model Number	List Price
18"W x 14"D x 24"H	38	WOCB6-181424-T	\$515	WOCB6-181424-L	\$754
18"W x 14"D x 30"H	41	WOCB6-181430-T	\$546	WOCB6-181430-L	\$827
24"W x 14"D x 24"H	47	WOCB6-241424-T	\$524	WOCB6-241424-L	\$778
24"W x 14"D x 30"H	50	WOCB6-241430-T	\$559	WOCB6-241430-L	\$854
30"W x 14"D x 24"H	55	WOCB6-301424-T	\$600	WOCB6-301424-L	\$912
30"W x 14"D x 30"H	58	WOCB6-301430-T	\$630	WOCB6-301430-L	\$983
36"W x 14"D x 24"H	64	WOCB6-361424-T	\$663	WOCB6-361424-L	\$1,057
36"W x 14"D x 30"H	67	WOCB6-361430-T	\$687	WOCB6-361430-L	\$1,125
42"W x 14"D x 24"H	78	WOCB6-421424-T	\$674	WOCB6-421424-L	\$1,071
42"W x 14"D x 30"H	82	WOCB6-421430-T	\$706	WOCB6-421430-L	\$1,144
48"W x 14"D x 24"H	87	WOCB6-481424-T	\$677	WOCB6-481424-L	\$1,071
48"W x 14"D x 30"H	92	WOCB6-481430-T	\$707	WOCB6-481430-L	\$1,145



- 2 fixed vertical partitions
- 6 adjustable shelves

Wall Cubicle Storage - 9 Cubicles (WOCB9)			Melamine	High-Pressure Laminate	
Description	Wgt.	Model Number	List Price	Model Number	List Price
18"W x 14"D x 24"H	41	WOCB9-181424-T	\$517	WOCB9-181424-L	\$755
18"W x 14"D x 30"H	44	WOCB9-181430-T	\$547	WOCB9-181430-L	\$828
24"W x 14"D x 24"H	52	WOCB9-241424-T	\$527	WOCB9-241424-L	\$779
24"W x 14"D x 30"H	55	WOCB9-241430-T	\$560	WOCB9-241430-L	\$855
30"W x 14"D x 24"H	62	WOCB9-301424-T	\$602	WOCB9-301424-L	\$913
30"W x 14"D x 30"H	65	WOCB9-301430-T	\$632	WOCB9-301430-L	\$986
36"W x 14"D x 24"H	72	WOCB9-361424-T	\$664	WOCB9-361424-L	\$1,058
36"W x 14"D x 30"H	75	WOCB9-361430-T	\$692	WOCB9-361430-L	\$1,126
42"W x 14"D x 24"H	87	WOCB9-421424-T	\$677	WOCB9-421424-L	\$1,073
42"W x 14"D x 30"H	92	WOCB9-421430-T	\$707	WOCB9-421430-L	\$1,145
48"W x 14"D x 24"H	98	WOCB9-481424-T	\$678	WOCB9-481424-L	\$1,073
48"W x 14"D x 30"H	103	WOCB9-481430-T	\$707	WOCB9-481430-L	\$1,147

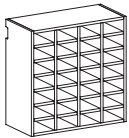

- 3 fixed vertical partitions
- 32 fixed shelves

Wall Cubicle Mail Storage (WOCBM)			Melamine	High-Pressure Laminate	
Description	Wgt.	Model Number	List Price	Model Number	List Price
30"W x 14"D x 30"H	72	WOCBM-301430-T	\$882	WOCBM-301430-L	\$1,487
36"W x 14"D x 30"H	83	WOCBM-361430-T	\$1,022	WOCBM-361430-L	\$1,777

P-ELEMENTSWALL-240114



- 1 fixed vertical partition
- 4 adjustable shelves

Wall Cupboard Cubicle Storage - 6 Cubicles (WCCB6)		Melamine			High-Pressure Laminate	
Description	Wgt.	Model Number	List Price	Model Number	List Price	
18"W x 14"D x 24"H	50	WCCB6-181424-TT-H?P?N	\$1,050	WCCB6-181424-LL-H?P?N	\$1,069	
18"W x 14"D x 30"H	56	WCCB6-181430-TT-H?P?N	\$1,085	WCCB6-181430-LL-H?P?N	\$1,128	
24"W x 14"D x 24"H	63	WCCB6-241424-TT-H?P?N	\$1,114	WCCB6-241424-LL-H?P?N	\$1,126	
24"W x 14"D x 30"H	70	WCCB6-241430-TT-H?P?N	\$1,172	WCCB6-241430-LL-H?P?N	\$1,193	
30"W x 14"D x 24"H	75	WCCB6-301424-TT-H?P?N	\$1,176	WCCB6-301424-LL-H?P?N	\$1,253	
30"W x 14"D x 30"H	83	WCCB6-301430-TT-H?P?N	\$1,209	WCCB6-301430-LL-H?P?N	\$1,311	
36"W x 14"D x 24"H	87	WCCB6-361424-TT-H?P?N	\$1,256	WCCB6-361424-LL-H?P?N	\$1,445	
36"W x 14"D x 30"H	96	WCCB6-361430-TT-H?P?N	\$1,311	WCCB6-361430-LL-H?P?N	\$1,508	
42"W x 14"D x 24"H	105	WCCB6-421424-TT-H?P?N	\$1,337	WCCB6-421424-LL-H?P?N	\$1,540	
42"W x 14"D x 30"H	116	WCCB6-421430-TT-H?P?N	\$1,391	WCCB6-421430-LL-H?P?N	\$1,628	
48"W x 14"D x 24"H	118	WCCB6-481424-TT-H?P?N	\$1,340	WCCB6-481424-LL-H?P?N	\$1,542	
48"W x 14"D x 30"H	130	WCCB6-481430-TT-H?P?N	\$1,392	WCCB6-481430-LL-H?P?N	\$1,629	



- 2 fixed vertical partitions
- 6 adjustable shelves

Wall Cupboard Cubicle Storage - 9 Cubicles (WCCB9)		Melamine			High-Pressure Laminate	
Description	Wgt.	Model Number	List Price	Model Number	List Price	
18"W x 14"D x 24"H	54	WCCB9-181424-TT-H?P?N	\$1,056	WCCB9-181424-LL-H?P?N	\$1,071	
18"W x 14"D x 30"H	59	WCCB9-181430-TT-H?P?N	\$1,086	WCCB9-181430-LL-H?P?N	\$1,131	
24"W x 14"D x 24"H	68	WCCB9-241424-TT-H?P?N	\$1,115	WCCB9-241424-LL-H?P?N	\$1,128	
24"W x 14"D x 30"H	75	WCCB9-241430-TT-H?P?N	\$1,149	WCCB9-241430-LL-H?P?N	\$1,195	
30"W x 14"D x 24"H	82	WCCB9-301424-TT-H?P?N	\$1,184	WCCB9-301424-LL-H?P?N	\$1,256	
30"W x 14"D x 30"H	89	WCCB9-301430-TT-H?P?N	\$1,210	WCCB9-301430-LL-H?P?N	\$1,312	
36"W x 14"D x 24"H	111	WCCB9-361424-TT-H?P?N	\$1,258	WCCB9-361424-LL-H?P?N	\$1,448	
36"W x 14"D x 30"H	104	WCCB9-361430-TT-H?P?N	\$1,313	WCCB9-361430-LL-H?P?N	\$1,509	
42"W x 14"D x 24"H	115	WCCB9-421424-TT-H?P?N	\$1,340	WCCB9-421424-LL-H?P?N	\$1,542	
42"W x 14"D x 30"H	126	WCCB9-421430-TT-H?P?N	\$1,392	WCCB9-421430-LL-H?P?N	\$1,629	
48"W x 14"D x 24"H	129	WCCB9-481424-TT-H?P?N	\$1,348	WCCB9-481424-LL-H?P?N	\$1,543	
48"W x 14"D x 30"H	141	WCCB9-481430-TT-H?P?N	\$1,393	WCCB9-481430-LL-H?P?N	\$1,634	

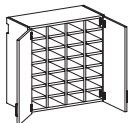

- 3 fixed vertical partitions
- 32 fixed shelves

Wall Cupboard Cubicle Mail Storage (WCCBM)		Melamine			High-Pressure Laminate	
Description	Wgt.	Model Number	List Price	Model Number	List Price	
30"W x 14"D x 30"H	96	WCCBM-301430-TT-H?P?N	\$1,727	WCCBM-301430-LL-H?P?N	\$1,983	
36"W x 14"D x 30"H	112	WCCBM-361430-TT-H?P?N	\$1,922	WCCBM-361430-LL-H?P?N	\$2,335	

P-ELEMENTSWALL-240114



- 1 fixed vertical partition
- 20 fixed shelves

Wall Open Folio Storage (WOF)		Melamine		High-Pressure Laminate	
Description	Wgt.	Model Number	List Price	Model Number	List Price
20"W x 14"D x 24"H	52	WOF-201424-T	\$942	WOF-201424-L	\$1,128
20"W x 14"D x 30"H	55	WOF-201430-T	\$968	WOF-201430-L	\$1,199
30"W x 14"D x 24"H	62	WOF-301424-T	\$1,059	WOF-301424-L	\$1,277
30"W x 14"D x 30"H	65	WOF-301430-T	\$1,092	WOF-301430-L	\$1,351
36"W x 14"D x 24"H	72	WOF-361424-T	\$1,164	WOF-361424-L	\$1,429
36"W x 14"D x 30"H	75	WOF-361430-T	\$1,191	WOF-361430-L	\$1,500



- 1 fixed vertical partition
- 20 fixed shelves

Wall Cupboard Folio Storage (WCF)		Melamine		High-Pressure Laminate	
Description	Wgt.	Model Number	List Price	Model Number	List Price
20"W x 14"D x 24"H	68	WCF-201424-TT-H?P?N	\$1,372	WCF-201424-LL-H?P?N	\$1,285
20"W x 14"D x 30"H	75	WCF-201430-TT-H?P?N	\$1,427	WCF-201430-LL-H?P?N	\$1,382
30"W x 14"D x 24"H	82	WCF-301424-TT-H?P?N	\$1,546	WCF-301424-LL-H?P?N	\$1,459
30"W x 14"D x 30"H	89	WCF-301430-TT-H?P?N	\$1,594	WCF-301430-LL-H?P?N	\$1,553
36"W x 14"D x 24"H	95	WCF-361424-TT-H?P?N	\$1,702	WCF-361424-LL-H?P?N	\$1,664
36"W x 14"D x 30"H	104	WCF-361430-TT-H?P?N	\$1,749	WCF-361430-LL-H?P?N	\$1,759

Set Up Charges and Upcharges for Non-Standard and Custom Finishes		
Model Number	Description	List Price
Group 2 Powder Coat	Set up charge, per color, per order, for Group 2 Powder Coat	\$329
Non-Standard PVC	Upcharge, per color, per order, for non-standard PVC	\$911

TERMS & CONDITIONS

Prices: All prices are F.O.B. the factory. Prices and specifications are subject to change without notice. Prices do not include applicable taxes, special handling or installation charges. Possession of a price list is not an offer to or agreement to sell. We reserve the right to change prices without notice. We are not responsible for typographical errors. In the event a price or description is found to be incorrect, the correct information will be communicated to you when the order is received.

Credit Terms: Open account status is only granted after a completed credit application is received and approved.

Payment Terms: Terms for open account are net 30 days. Terms for orders without open account will be determined by Silver Street, Incorporated on an order-by-order basis and may require prepayment or a 50% deposit with order and the balance prepaid before shipment.

Orders: Orders must be in writing. Faxed orders are acceptable. Processing of orders will not begin until a signed acknowledgment is received.

Acknowledgments: Orders are accepted, manufactured and invoiced based on written acknowledgments issued by Silver Street, Incorporated. All orders are considered correct as acknowledged. Notify Silver Street, Incorporated immediately of any order discrepancies. Acknowledged orders may not be changed or canceled without written consent from Silver Street, Incorporated.

Changes to orders: Changes to orders already in process may be subject to a fee covering the cost to make the requested change. If a fee is necessary a written authorization of acceptance will be required. All requests for changes are subject to approval by Silver Street, Incorporated.

Cancellation of orders: All orders received by Silver Street, Incorporated are considered firm and cannot be canceled without our approval. A cancellation fee may be required based upon cost incurred by Silver Street, Incorporated prior to receipt of a cancellation request.

Returns: Returns are not accepted without a Return Goods Authorization issued by Silver Street, Incorporated. Unauthorized returns will not be accepted. Returns may be subject to a restocking fee.

Shipping Terms: All orders will be shipped F.O.B. shipping point with freight charged collect. Shipping weights listed are net.

Routing: Shipments will be routed "best way" or as specified. Instructions will be followed as closely as possible, however, Silver Street, Incorporated reserves the right to make changes due to local conditions or other circumstances.

Freight Damage: Legal title to merchandise passes to the buyer upon acceptance by the carrier. All cartons must be carefully inspected at the time of delivery. Visible damage should be noted on the delivery receipt. In the case of concealed damage, the carrier must be notified within (5) days. It is the buyer's obligation to seek recourse against the shipper.

Shortages: Shipments should be inspected upon receipt for shortages. Shortages must be reported to Silver Street, Incorporated in writing within (5) days of receipt.

Shipping Address: **mediatechnologies®**
892 Industrial Park Drive
Shelby, MI 49455

Warranty: All items manufactured by Silver Street, Incorporated, home of mediatechnologies® and Elements by mediatechnologies are guaranteed against defects for a period of five (5) years from the date of purchase. We will repair or replace, in our discretion, any defective item without cost to our customer. This is customer's sole and exclusive remedy against us. No delay in shipment or delivery shall give rise to any liability for damages whatsoever. We are not liable for defects caused by customer or any third party. Customer is not authorized to make any repairs whatsoever or to deduct any amount from the purchase price. In no event shall our liability under this warranty exceed the purchase price. In no event shall we be liable for incidental, special or consequential damages. We disclaim all other warranties, express or implied, as to any matter whatsoever, including without limitation, quality, design, performance, specifications, samples, condition, merchantability and fitness for any particular purpose. No action may be commenced for breach of the warranty more than six months after the cause of action accrues and any such action may only be brought in the county of Oceana, State of Michigan.

elements
by mediatechnologies®
is a registered trademark of Silverstreet Incorporated.

U.S. Patent # 8,434,835 B2

P-ELEMENTSWALL-240114